

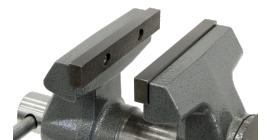

Multi-Purpose Bench Vise, 5-1/2" Jaw Width", 360° Rotating Head & Base

Product Images





Description

Wilton's Multi-Purpose Bench Vise is ideal for light tradesman, utility, MRO and general purpose use. This vise features a 360 degree rotating head to clamp material at any angle, 30 degree indexing increments for quick set up, replaceable pipe jaws and a V-jaw to easily hold round objects vertically. The body and movable jaw are 30,000 PSI gray cast iron and the base is 60,000 PSI ductile iron, providing durability through a wide range of applications.

Additional Information

SKU	28824
Jaw Width (In.)	5-1/2
Number of Mounting Points	4
Opening Capacity Max (In.)	5
Pipe Jaw Capacity (In.)	5/8 — 2-1/4
Prop 65	Cancer and Reproductive Harm
Throat Depth (In.)	2-3/4
Type of Base	360 Degree Swivel

